

GPQH

FASTENERS

GPQH

Hex Socket Head Thumb Screws

303 Stainless Steel

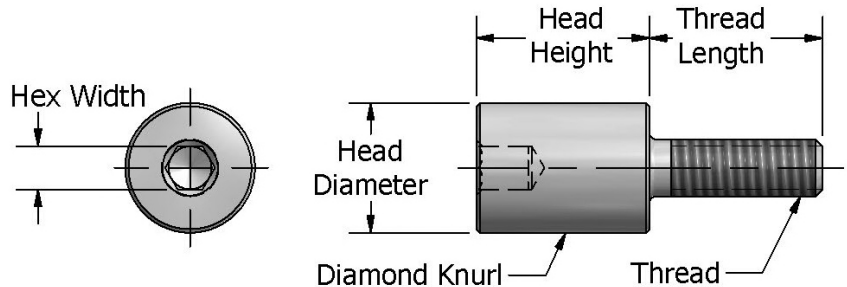

Part Number	Thread	Thread Length	Head Diameter	Head Height	Hex Width
GPQH-1	#4-40	1/2"	1/4"	1/2"	5/64"
GPQH-2	#4-40	3/4"	1/4"	1/2"	5/64"
GPQH-3	#4-40	1/2"	5/16"	1/2"	3/32"
GPQH-4	#4-40	3/4"	5/16"	1/2"	3/32"
GPQH-5	#4-40	3/8"	3/8"	1/2"	1/8"
GPQH-6	#4-40	1/2"	3/8"	1/2"	1/8"
GPQH-7	#6-32	1/2"	1/4"	1/2"	5/64"
GPQH-8	#6-32	3/4"	1/4"	1/2"	5/64"
GPQH-9	#6-32	1"	1/4"	1/2"	5/64"
GPQH-10	#6-32	1/2"	5/16"	1/2"	3/32"
GPQH-11	#6-32	3/4"	5/16"	1/2"	3/32"
GPQH-12	#6-32	1"	5/16"	1/2"	3/32"
GPQH-13	#6-32	3/8"	3/8"	1/2"	1/8"
GPQH-14	#6-32	1/2"	3/8"	1/2"	1/8"
GPQH-15	#8-32	1/2"	1/4"	1/2"	5/64"
GPQH-16	#8-32	3/4"	1/4"	1/2"	5/64"
GPQH-17	#8-32	1"	1/4"	1/2"	5/64"
GPQH-18	#8-32	1/2"	5/16"	1/2"	3/32"
GPQH-19	#8-32	3/4"	5/16"	1/2"	3/32"
GPQH-20	#8-32	1"	5/16"	1/2"	3/32"
GPQH-21	#8-32	3/8"	3/8"	1/2"	1/8"
GPQH-22	#8-32	1/2"	3/8"	1/2"	1/8"
GPQH-23	#10-24	1/2"	5/16"	3/16"	3/32"
GPQH-24	#10-24	3/4"	5/16"	3/16"	3/32"
GPQH-25	#10-24	1"	5/16"	3/16"	3/32"
GPQH-26	#10-24	1-1/4"	5/16"	3/16"	3/32"
GPQH-27	#10-24	1/2"	3/8"	1/2"	1/8"
GPQH-28	#10-24	3/4"	3/8"	1/2"	1/8"
GPQH-29	#10-24	1"	3/8"	1/2"	1/8"
GPQH-30	#10-24	1-1/4"	3/8"	1/2"	1/8"
GPQH-31	#10-32	1/2"	5/16"	3/16"	3/32"
GPQH-32	#10-32	3/4"	5/16"	3/16"	3/32"
GPQH-33	#10-32	1"	5/16"	3/16"	3/32"
GPQH-34	#10-32	1-1/4"	5/16"	3/16"	3/32"
GPQH-35	#10-32	1/2"	3/8"	1/2"	1/8"
GPQH-36	#10-32	3/4"	3/8"	1/2"	1/8"
GPQH-37	#10-32	1"	3/8"	1/2"	1/8"
GPQH-38	#10-32	1-1/4"	3/8"	1/2"	1/8"