

811  
816

# COUPLINGS

## Cardan Jaw

Extended Length & Improved Misalignment

811  
816

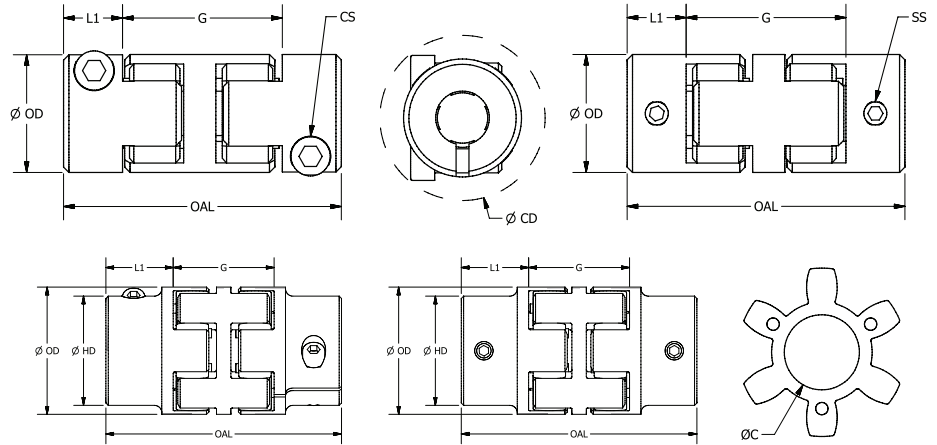

### Performance

Coupling Code		Coupling Size	OD (in)	OAL (in)		Spider Shore Hardness	Spider Color	Misalignment			Max RPM*	Torque (in-lb)			Torsional Stiffness (in-lb/rad)	
Set Screw	Clamp			K1	K2			Axial	Radial			Angular	Nominal	Max		Reversing
811	812	14	0.55	1.25	2.25	80A	Blue	0.030	.024	.058	2°	8500	6	12	2	38
813	814	14	0.55	1.25	2.25	92A	White	0.030	.024	.058	2°	8500	11	21	2	64
815	816	14	0.55	1.25	2.25	98A	Red	0.030	.024	.058	2°	8500	18	35	2	102
811	812	20	0.78	1.75	3.75	80A	Blue	0.030	.033	.100	2°	5900	16	32	4	76
813	814	20	0.78	1.75	3.75	92A	White	0.030	.033	.100	2°	5900	27	53	4	140
815	816	20	0.78	1.75	3.75	98A	Red	0.030	.033	.100	2°	5900	44	89	4	228
811	812	30	1.18	2.00	4.50	80A	Blue	0.030	.039	.120	2°	3900	35	71	9	269
813	814	30	1.18	2.00	4.50	92A	White	0.030	.039	.120	2°	3900	66	133	9	505
815	816	30	1.18	2.00	4.50	98A	Red	0.030	.039	.120	2°	3900	111	221	9	759
811	812	40	1.57	3.25	6.25	80A	Blue	0.050	.064	.120	2.4°	3500	43	86	11	1000
813	814	40	1.57	3.25	6.25	92A	White	0.050	.064	.120	2.4°	3500	88	177	23	3000
815	816	40	1.57	3.25	6.25	98A	Red	0.050	.064	.120	2.4°	3500	150	300	39	5000
811	812	55	2.16	4.00	7.00	80A	Blue	0.060	.052	.190	1.8°	3000	151	301	39	4000
813	814	55	2.16	4.00	7.00	92A	White	0.060	.052	.190	1.8°	3000	310	620	80	9500
815	816	55	2.16	4.00	7.00	98A	Red	0.060	.052	.190	1.8°	3000	530	1060	142	16500

\*Max RPM for Set Style

### Complete Dimensions

Coupling Size	Inch or Metric		OD (in)	HD (in)	OAL (in)		L1 (in)	G (in)		C (in)	SS	CS	CD (in)
	Min Bore	Max Bore			K1	K2		K1	K2				
14	3mm	7mm	0.55	0.55	1.25	2.25	0.28	0.69	1.69	-	#6-32	#4-40	0.71
20	4mm	9mm	0.78	0.78	1.75	3.75	0.39	0.97	2.97	-	#8-32	#5-40	0.93
30	1/4"	14mm	1.18	1.18	2.00	4.50	0.43	1.14	3.64	0.34	#8-32	#6-32	1.27
40	5/16"	24mm	1.57	1.57	3.50	6.50	0.98	1.54	4.54	0.69	1/4-20	#10-24	1.70
55	3/8"	32mm	2.16	1.86	4.00	7.00	1.16	1.68	4.68	1.04	5/16-18	1/4-20	2.20

### Materials

Hubs: Aluminum  
Fasteners: Alloy Steel  
Spiders: Polyurethane  
Temp Range: -40°F to 212°F

**812 . 65 . 3636** = Size 65, Clamp Style, 80A Spider, 1/2" Bores

