

GPQ

FASTENERS

Plain Head Thumb Screw

GPQ

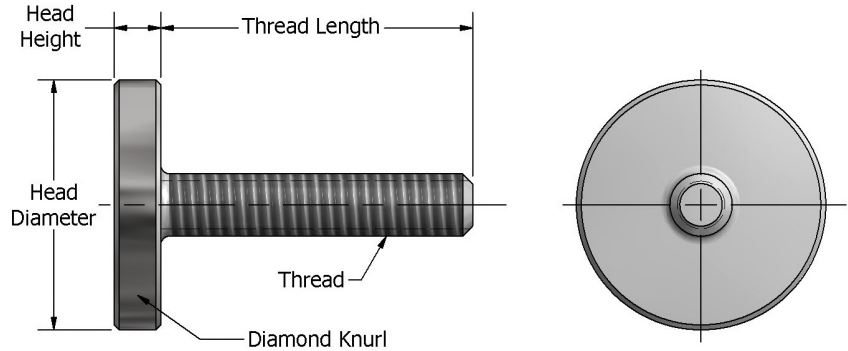

Part Number		Thread	Thread Length	Head Diameter	Head Height
303 Stainless	416 Stainless				
GPQ-1-3	GPQ-1	#4-40	3/8"	1/4"	1/8"
GPQ-4-3	---	#4-40	3/8"	3/8"	1/8"
GPQ-2-3	---	#4-40	1/2"	1/4"	1/2"
GPQ-5-3	GPQ-5	#4-40	1/2"	3/8"	1/8"
GPQ-3-3	---	#4-40	3/4"	1/4"	1/2"
---	GPQ-4	#4-40	1-3/8"	3/8"	1/8"
GPQ-9-3	GPQ-9	#6-32	3/8"	3/8"	1/8"
GPQ-6-3	---	#6-32	1/2"	1/4"	1/2"
GPQ-10-3	GPQ-10	#6-32	1/2"	3/8"	1/8"
GPQ-7-3	---	#6-32	3/4"	1/4"	1/2"
GPQ-8-3	---	#6-32	1"	1/4"	1/2"
GPQ-14-3	GPQ-14	#8-32	3/8"	3/8"	1/8"
GPQ-11-3	---	#8-32	1/2"	1/4"	1/2"
GPQ-15-3	GPQ-15	#8-32	1/2"	3/8"	1/8"
GPQ-12-3	---	#8-32	3/4"	1/4"	1/2"
GPQ-13-3	---	#8-32	1"	1/4"	1/2"
GPQ-16-3	GPQ-16	#10-24	1/2"	3/8"	3/16"
GPQ-21-3	GPQ-21	#10-24	1/2"	1/2"	3/16"
GPQ-17-3	GPQ-17	#10-24	3/4"	3/8"	3/16"
GPQ-20-3	GPQ-20	#10-24	3/4"	1/2"	3/16"
GPQ-24-3	GPQ-24	#10-24	3/4"	3/4"	3/16"
GPQ-18-3	GPQ-18	#10-24	1"	3/8"	3/16"
GPQ-25-3	GPQ-25	#10-24	1"	3/4"	3/16"
GPQ-23-3	GPQ-23	#10-24	1-1/2"	1/2"	3/16"
GPQ-27-3	GPQ-27	#10-24	1-1/2"	3/4"	3/16"
GPQ-19-3	GPQ-19	#10-24	1-1/4"	3/8"	3/16"
GPQ-22-3	GPQ-22	#10-24	1-1/4"	1/2"	3/16"
GPQ-26-3	GPQ-26	#10-24	1-1/4"	3/4"	3/16"

Part Number		Thread	Thread Length	Head Diameter	Head Height
303 Stainless	416 Stainless				
GPQ-28-3	GPQ-28	#10-32	1/2"	3/8"	3/16"
GPQ-29-3	GPQ-29	#10-32	3/4"	3/8"	3/16"
GPQ-32-3	GPQ-32	#10-32	3/4"	1/2"	3/16"
GPQ-36-3	GPQ-36	#10-32	3/4"	3/4"	3/16"
GPQ-30-3	GPQ-30	#10-32	1"	3/8"	3/16"
GPQ-33-3	GPQ-33	#10-32	1"	1/2"	3/16"
GPQ-37-3	GPQ-37	#10-32	1"	3/4"	3/16"
GPQ-31-3	GPQ-31	#10-32	1-1/4"	3/8"	3/16"
GPQ-34-3	GPQ-34	#10-32	1-1/4"	1/2"	3/16"
GPQ-38-3	GPQ-38	#10-32	1-1/4"	3/4"	3/16"
GPQ-35-3	GPQ-35	#10-32	1-1/2"	1/2"	3/16"
GPQ-39-3	GPQ-39	#10-32	1-1/2"	3/4"	3/16"
GPQ-40-3	GPQ-40	#1/4-20	3/4"	3/4"	3/16"
GPQ-45-3	GPQ-45	#1/4-20	3/4"	1"	3/16"
GPQ-41-3	GPQ-41	#1/4-20	1"	3/4"	3/16"
GPQ-46-3	GPQ-46	#1/4-20	1"	1"	3/16"
GPQ-42-3	GPQ-42	#1/4-20	1-1/4"	3/4"	3/16"
GPQ-47-3	GPQ-47	#1/4-20	1-1/4"	1"	3/16"
GPQ-43-3	GPQ-43	#1/4-20	1-1/2"	3/4"	3/16"
GPQ-48-3	GPQ-48	#1/4-20	1-1/2"	1"	3/16"
GPQ-44-3	GPQ-44	#1/4-20	2"	3/4"	3/16"
GPQ-49-3	GPQ-49	#1/4-20	2"	1"	3/16"