

K16

GEARBOXES

K16

Bevel T Gearbox

Molded Glass Filled Nylon Housing

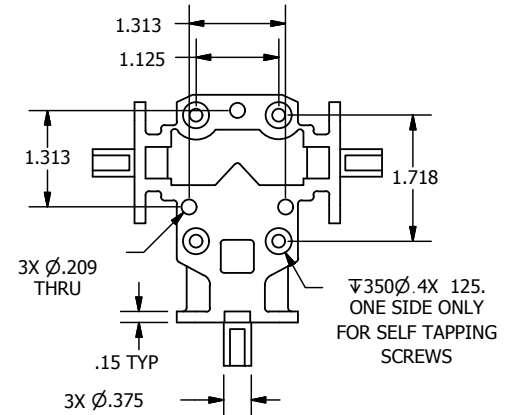
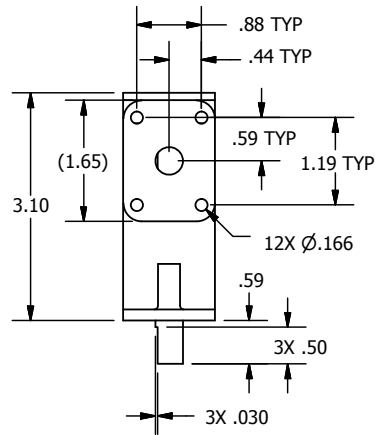

Part Number	Ratio	Efficiency at 1000 Rpm
K16-1	1:1	88%
K16-2	2:1	88%

Materials:

Glass Filled Nylon Housing
Precision Ground Steel Shafts
Hardened Steel Bevel Gears

Weight: 0.60 lb

Max. Input Speed: 3000 RPM

Different Customizations Options Available:

Stainless Steel Shafts
Single Shaft Output
Shaft Key-ways

Output Torque oz.in

RPM Input	Reduction Ratio	
	1:1	2:1
3450	6.41	11.60
1725	6.84	12.32
860	7.33	13.12

Testing in your application is necessary. You will need to assess duty cycles and confirm gearbox suitability with your own calculations. All figures listed are to be used for guidance only.