

K40H

GEARBOXES

K40H

Worm & Wheel Reduction Gearbox

Molded Housings, Hollow Bore Output, 3:5:1 - 60:1

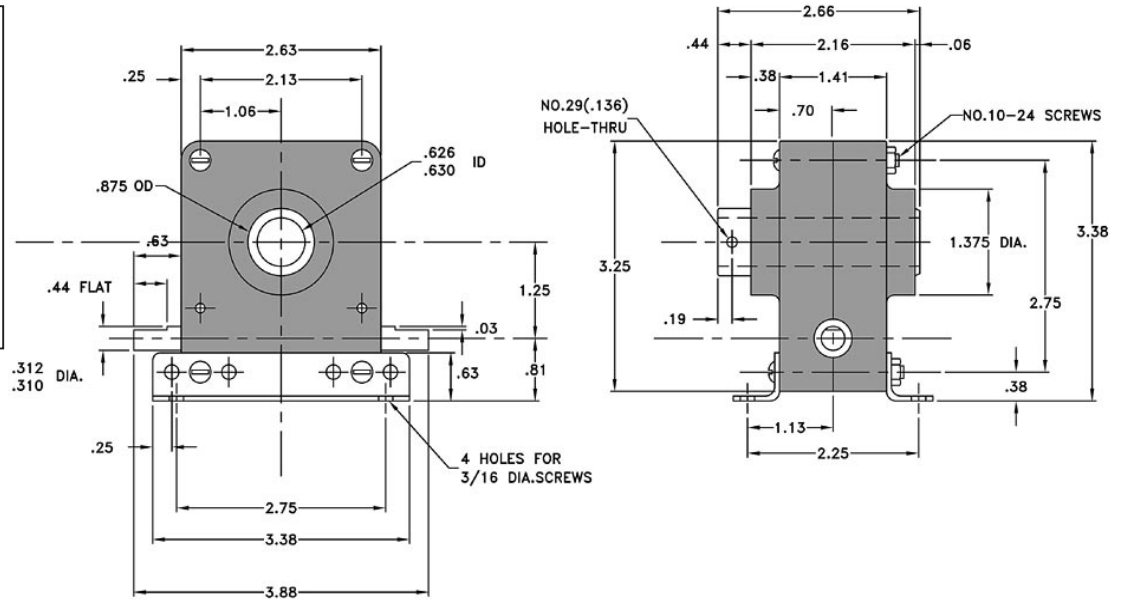

Hollow Bore Output	Ratio	Input RPM	Output RPM	Output Torque	
				inch-LBS	Nm
K40H-3.5	3:5:1	1800	514.3	102	11.6
K40H-10	10:1	1800	180	102	11.6
K40H-15	15:1	1800	120	102	11.6
K40H-20	20:1	1800	90	105	11.9
K40H-30	30:1	1800	60	120	13.6
K40H-40	40:1	1800	45	112	12.7
K40H-48	48:1	1800	37.5	96	10.9
K40H-60	60:1	1800	30	75	8.5

Materials

Housing: Compression-molded glass filled polyster

Worm: Ground steel worm

Wheel: Bronze, precision hobbled

Modifications and custom designed gearboxes available. Customizing such as Stainless Steel shafting, longer shafts for input/output, and internal keyways on K40H output bores. Testing in your application is necessary. You will need to assess duty cycles and confirm suitability with your own calculations. All figures listed are to be used for guidance only.

Specifications

Size: 3-3/8"H x 3-7/8"W x 3"D

Weight: less than 20 ounces

Input: Dual shaft 0.312" diameter with flats, steel, 0.63" long

Output: 0.625" diameter ground and polished steel with cross hole for securing shaft

Bearings: Input/Output shafts supported by sintered bronze bushings

Mounting: 8 different positions of the mounting flanges

ondrives.us

1-888-260-7466
516-771-6444

sales@ondrivesus.com
www.ondrivesus.com

K50H

GEARBOXES

K50H

Worm & Wheel Reduction Gearbox

Molded Housings, Hollow Bore Output, **5:1 - 100:1**

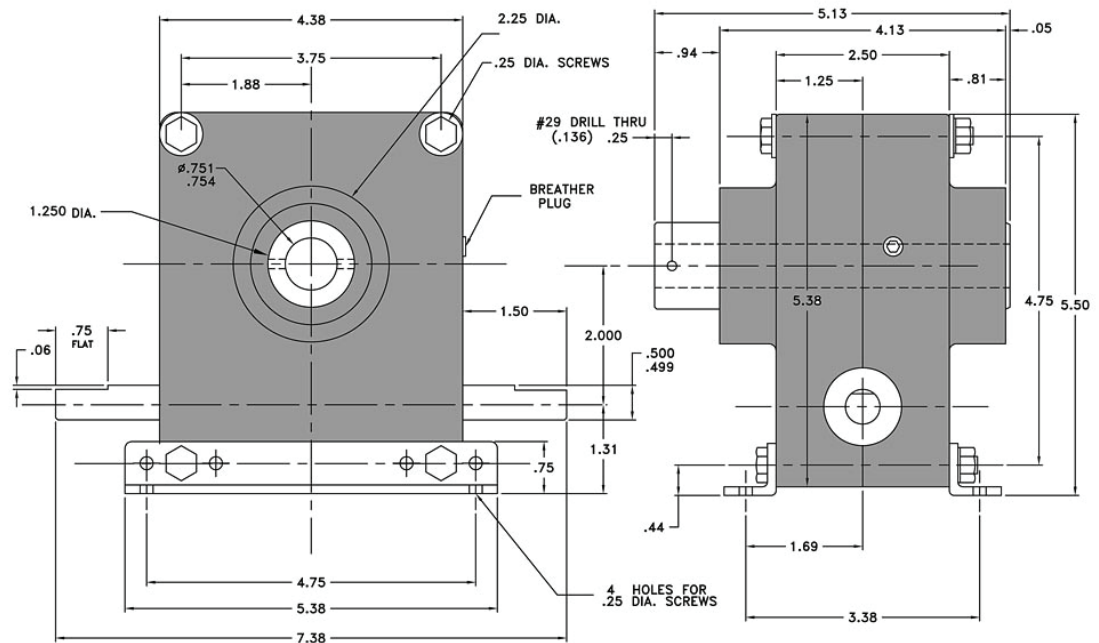
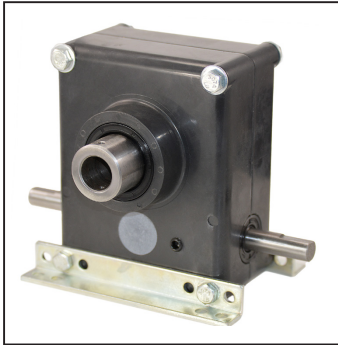

Hollow Bore Output	Ratio	Input RPM	Output RPM	Output Torque	
				inch-LBS	Nm
K50H-5	5:1	1800	360	140	15.8
K50H-9	9:1	1800	200	175	19.7
K50H-18	18:1	1800	100	190	21.4
K50H-25	25:1	1800	72	190	21.4
K50H-36	36:1	1800	50	190	21.4
K50H-50	50:1	1800	36	190	21.4
K50H-100	100:1	1800	18	195	22.1

Materials

Housing: Compression-molded glass filled polyster

Worm: Ground steel worm

Wheel: Bronze, precision hobbled

Modifications and custom designed gearboxes available. Customizing such as Stainless Steel shafting, longer shafts for input/output, and internal keyways on K40H output bores. Testing in your application is necessary. You will need to assess duty cycles and confirm suitability with your own calculations. All figures listed are to be used for guidance only.

Specifications

Size: 5-1/2"H x 7-7/8"W x 5-9/16"D

Weight: 9 pounds

Input: Dual shaft 0.500" diameter with flats, steel, 0.xx" long

Output: 0.750" diameter steel bore, 1.25 OD cross hole for securing shaft

Bearings: Input/Output shafts supported by sintered bronze bushings plus anti-friction thrust bearings

Mounting: 8 different positions of the mounting flanges

ondrives.us

1-888-260-7466
516-771-6444

sales@ondrivesus.com
www.ondrivesus.com