

811
816

COUPLINGS

Cardan Jaw

Extended Length & Improved Misalignment

811
816

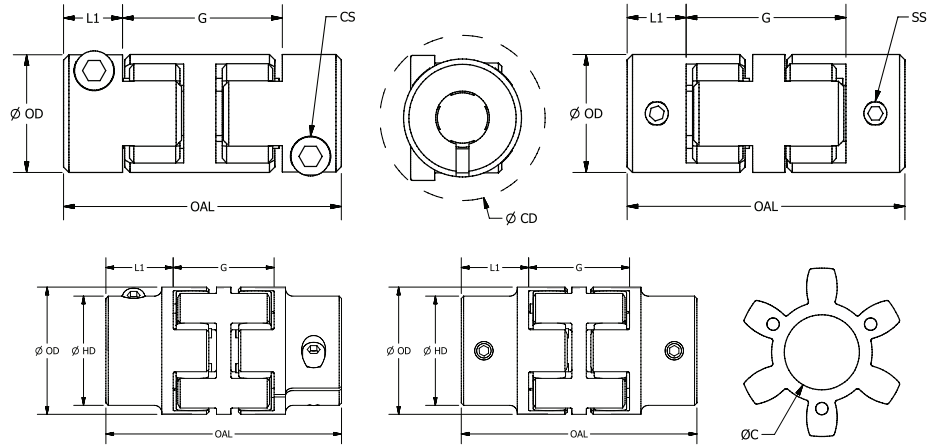

Performance

Coupling Code		Coupling Size	OD (in)	OAL (in)		Spider Shore Hardness	Spider Color	Misalignment			Max RPM*	Torque (in-lb)			Torsional Stiffness (in-lb/rad)	
Set Screw	Clamp			K1	K2			Axial	Radial			Angular	Nominal	Max		Reversing
811	812	14	0.55	1.25	2.25	80A	Blue	0.030	0.005	0.023	2.0	8500	6	12	2	38
813	814	14	0.55	1.25	2.25	92A	White	0.030	0.005	0.023	2.0	8500	11	21	2	64
815	816	14	0.55	1.25	2.25	98A	Red	0.030	0.005	0.023	2.0	8500	18	35	2	102
811	812	20	0.78	1.75	3.75	80A	Blue	0.030	0.006	0.041	2.0	5900	16	32	4	76
813	814	20	0.78	1.75	3.75	92A	White	0.030	0.006	0.041	2.0	5900	27	53	4	140
815	816	20	0.78	1.75	3.75	98A	Red	0.030	0.006	0.041	2.0	5900	44	89	4	228
811	812	30	1.18	2.00	4.50	80A	Blue	0.030	0.006	0.050	2.0	3900	35	71	9	269
813	814	30	1.18	2.00	4.50	92A	White	0.030	0.006	0.050	2.0	3900	66	133	9	505
815	816	30	1.18	2.00	4.50	98A	Red	0.030	0.006	0.050	2.0	3900	111	221	9	759
811	812	40	1.57	3.25	6.25	80A	Blue	0.050	0.023	0.086	2.4	3500	43	86	11	1000
813	814	40	1.57	3.25	6.25	92A	White	0.050	0.023	0.086	2.4	3500	88	177	23	3000
815	816	40	1.57	3.25	6.25	98A	Red	0.050	0.023	0.086	2.4	3500	150	300	39	5000
811	812	55	2.16	4.00	7.00	80A	Blue	0.060	0.023	0.071	1.8	3000	151	301	39	4000
813	814	55	2.16	4.00	7.00	92A	White	0.060	0.023	0.071	1.8	3000	310	620	80	9500
815	816	55	2.16	4.00	7.00	98A	Red	0.060	0.023	0.071	1.8	3000	530	1060	142	16500

*Max RPM for Set Style

Complete Dimensions

Coupling Size	Inch or Metric		OD (in)	HD (in)	OAL (in)		L1 (in)	G (in)		C (in)	SS	CS	CD (in)
	Min Bore	Max Bore			K1	K2		K1	K2				
14	3mm	7mm	0.55	0.55	1.25	2.25	0.28	0.69	1.69	-	#6-32	#4-40	0.71
20	4mm	9mm	0.78	0.78	1.75	3.75	0.39	0.97	2.97	-	#8-32	#5-40	0.93
30	1/4"	14mm	1.18	1.18	2.00	4.50	0.43	1.14	3.64	0.34	#8-32	#6-32	1.27
40	5/16"	24mm	1.57	1.57	3.50	6.50	0.98	1.54	4.54	0.69	1/4-20	#10-24	1.70
55	3/8"	32mm	2.16	1.86	4.00	7.00	1.16	1.68	4.68	1.04	5/16-18	1/4-20	2.20

Materials

Hubs: Aluminum
Fasteners: Alloy Steel
Spiders: Polyurethane
Temp Range: -40°F to 212°F