

277/285
EAM/EFM

Oldham Coupling-Clutch

Clutch and Misalignment Coupling in One



- System protection and misalignment compensation in one device
- Torque to 500 in-lb in 7 sizes
- 2 degree maximum backlash
- Set screw fixing
- Use as torque limiter, tensioner or overrun device

Part No.		Style	Torque (in-lb)		Capacity @50 RPM		Bore B1		Bore B2		OD (in)	OAL (in.)		L1 (in)****		L2 (in)	Min Shaft Gap (in)
Adj. Torque	Fixed Torque		Oldham (Peak)	Max Adj.	in-lb	Watts	Min	Max	Min	Max		Style 1,2,3	Style 4	Style 1,2,3	Style 4		
277.25	-	1	35	4.7	4.7	3	6mm	8mm	6mm	12mm	1.02	1.83	-	0.95	-	0.34	0.54
285.25	-	1	35	11.7	11.7	7	6mm	8mm	6mm	12mm	1.02	2.10	-	1.20	-	0.34	0.56
EAM16	EFM16	2, 4	35	16	16	9	6mm	10mm	6mm	12mm	1.00	2.45	2.14	1.50	1.19	0.46	0.49
EAM24	EFM24	2, 4	80	25	25	15	8mm	13mm	8mm	16mm	1.38	4.02	3.52	2.50	2.00	0.59	0.93
EAM32	EFM32	2, 4	150	50	50	30	12mm	16mm	0.375"	20mm	1.63	3.94	3.37	2.44	1.87	0.70	0.80
EAM44	EFM44	2, 4	265	75	75	43	12mm	16mm	0.375"	25mm	2.25	4.29	3.72	2.44	1.87	0.81	1.04
EAM52	-	3	390	500**	500***	85***	0.750"	1.250"	12mm	30mm	3.25	6.57	-	4.00	-	1.12	1.45

Notes

2 Degree maximum backlash.
Angular Misalignment: 2°, all sizes and styles.
Radial Misalignment: 0.016" (277 to 24)
0.020" (32 to 52)

Watts=Torque(Lb.in.) x RPM x Duty Cycle x .0113
1000 RPM maximum continuous speed at light load*
175°F, maximum permissible surface temperature.
HEAM version for 50% higher torque in Style 2, heat capacity is unchanged.

- * Fixed torque versions are made to order, specify torque required.
- ** Maximum torque possible only with higher capacity Oldham disc, please inquire.
- *** Maximum capacity, heat generation in watts must be taken into consideration.
- **** Shaft must extend to L2 depth to properly support clutch housing.

OLDHAM SERVICE FACTOR	
Duty	Factor
Momentary	1
1 hr per day	2
3 hrs per day	4
6 hrs per day	6
12 hrs per day	8

Peak Torque, select a size where Peak Torque exceeds the application torque x service factor

- See next page for dimensions and drawings
 - See our website for CAD files
- Online Ordering Available

ondrives.US Corp.

216 N. Main St., Freeport, NY 11520
ISO9001:2008 Certified

phone: 888-260-7466
fax: 516-771-6444

www.ondrivesUS.com
sales@ondrivesUS.com

277/285
EAM/EFM

Oldham Coupling-Clutch

Clutch and Misalignment Coupling in One

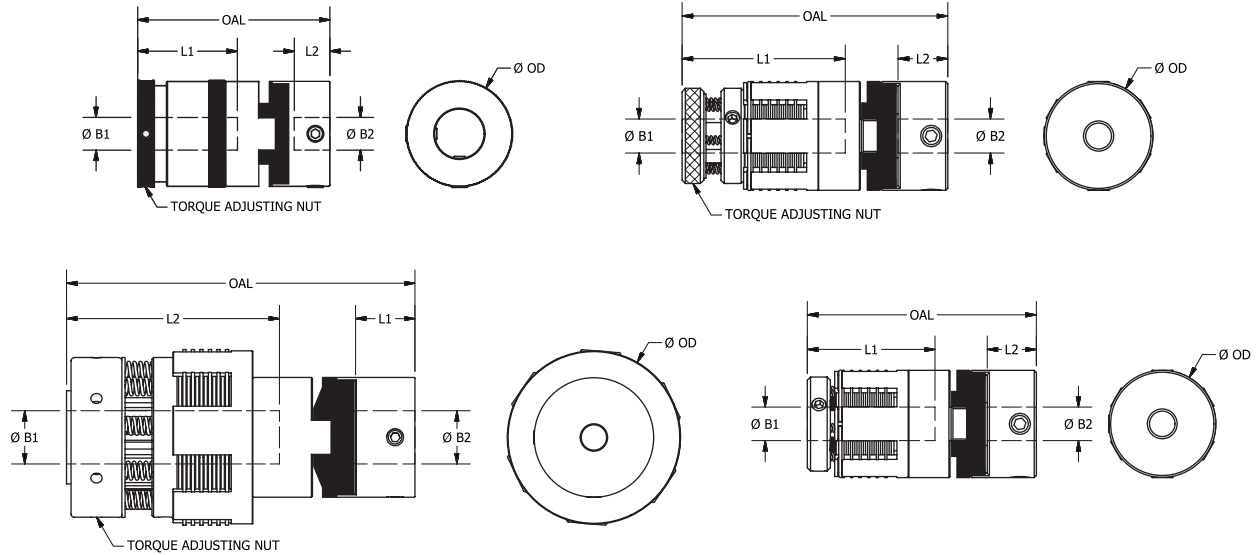

SIZE	AVAILABLE BORES B1																				
	INCH										METRIC										
	1/4	5/16	3/8	1/2	5/8	3/4	7/8	1	1-1/8	1-1/4	6	8	10	12	14	15	16	20	24	25	30
277.25	•	•									•	•									
285.25	•	•									•	•									
EAM16	•	•	•								•	•									
EAM24	•	•	•	•							•	•	•	•							
EAM32	•	•	•	•	•						•	•	•	•	•						
EAM44	•	•	•	•	•						•	•	•	•	•	•					
EAM52				•	•	•	•	•	•	•			•	•	•	•	•	•	•	•	
Code	24	27	31	36	41	47	50	53	55	57	22	28	35	38	40	42	48	51	52	56	56

SIZE	AVAILABLE BORES B2																				
	INCH										METRIC										
	1/4	5/16	3/8	1/2	5/8	3/4	7/8	1	1-1/8	1-1/4	6	8	10	12	14	15	16	20	24	25	30
277.25	•	•	•	•							•	•	•								
285.25	•	•	•	•							•	•	•								
EAM16	•	•	•	•							•	•	•								
EAM24		•	•	•	•							•	•	•	•	•					
EAM32			•	•	•	•						•	•	•	•	•					
EAM44			•	•	•	•	•	•	•				•	•	•	•	•	•	•	•	
EAM52				•	•	•	•	•	•	•			•	•	•	•	•	•	•	•	
Code	24	27	31	36	41	47	50	53	55	57	22	28	35	38	40	42	48	51	52	56	56

• See our website for CAD files
Online Ordering Available

ondrives.US Corp.

216 N. Main St., Freeport, NY 11520
ISO9001:2008 Certified

phone: 888-260-7466
fax: 516-771-6444

www.ondrivesUS.com
sales@ondrivesUS.com