

**NT91
NH91**

GEARBOXES

Inline Spur Gear Reducers

15mm Double or Single Shaft, 10 - 35 Nm **1:1 - 9:1**

**NT91
NH91**

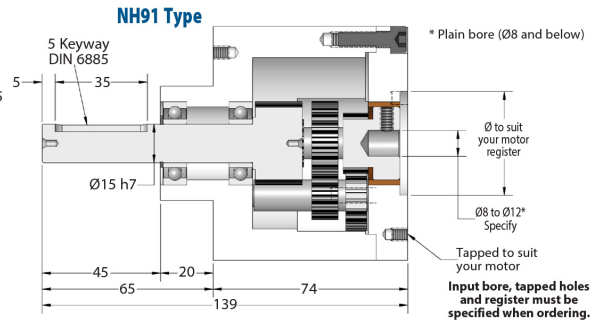
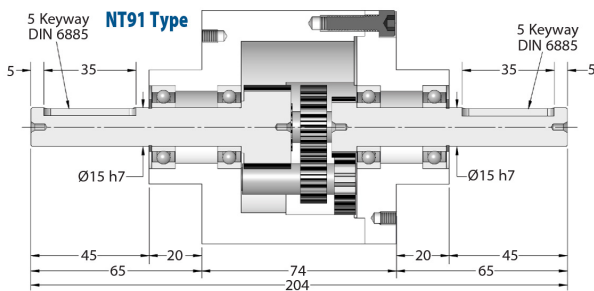
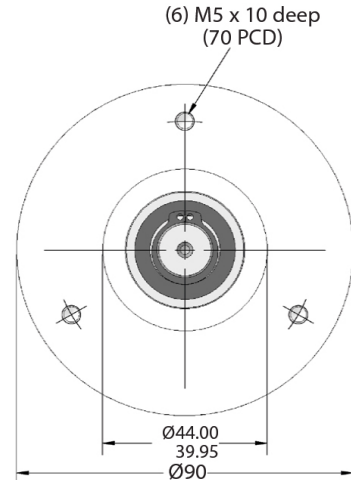

Part Number		Ratio	Efficiency at 1000 Rpm	Nm Output at 1000 Rpm	Standard Direction
NT91-1/OPP	NH91-1/OPP	1:1	90%	15	Opposite
NT91-2	NH91-2	2:1	90%	15	Same
NT91-3	NH91-3	3:1	90%	16	Same
NT91-4	NH91-4	4:1	90%	17	Same
NT91-5	NH91-5	5:1	90%	18	Opposite
NT91-6	NH91-6	6:1	90%	19	Opposite
NT91-8	NH91-8	8:1	90%	19	Opposite
NT91-9	NH91-9	9:1	90%	20	Opposite
NT91-SP	NH91-SP	1:1 - 9:1			

Special Ratios : Replace **SP** with required ratio

NT91 Weight: 1.6 kg.
 Backlash: Depends on ratio.
 Max. Input Speed: 3,000 Rpm.
 Greased for Life: Shell Gadus S5 V42P 2.5.
 Max. Overhung and Thrust Loads at 1000 Rpm:
 Output Overhung Load (F_{xa}) = 20 kg. Output Thrust Load (F_a) = 15 kg.
 Shaft Keys: KK5-35.

Testing in your application is necessary.
 You will need to assess duty cycles and confirm gearbox suitability with your own calculations.
 All figures listed are to be used for guidance only.

Output Torque Nm

RPM Input	Reduction Ratio							
	1:1	2:1	3:1	4:1	5:1	6:1	8:1	9:1
3000	10	10	11	12	12	14	14	15
2000	12	12	13	14	15	16	16	17
1000	15	15	16	17	18	19	19	20
500	18	18	18	19	21	22	22	23
200	21	21	22	22	24	25	25	26
100	24	24	25	26	26	27	28	29
50	27	27	27	28	28	31	32	32
10	30	30	30	30	30	33	35	35