

GEARBOXES

Precision Worm Gear Reducers

Flange Input 10.3 – 40 Nm **5:1 - 120:1**

e-cad
Drawings
Available

PF45

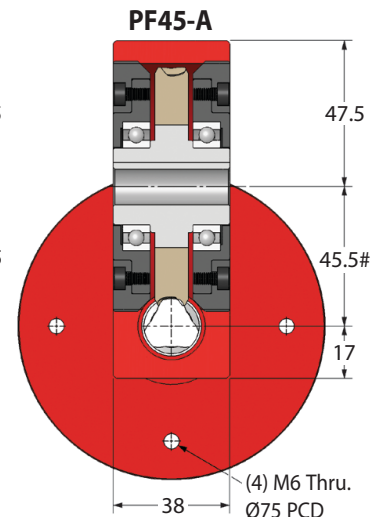
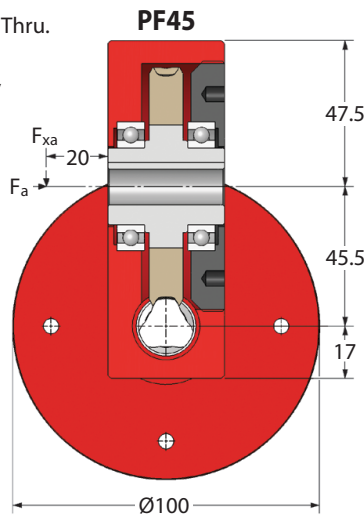
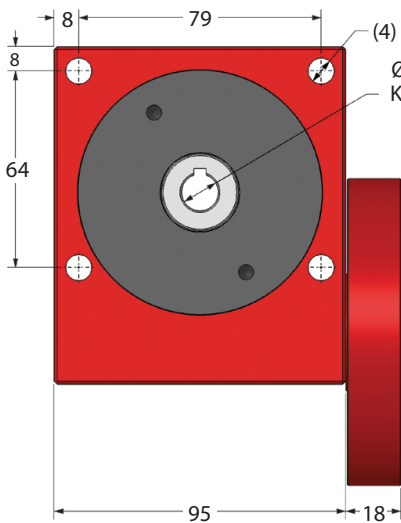
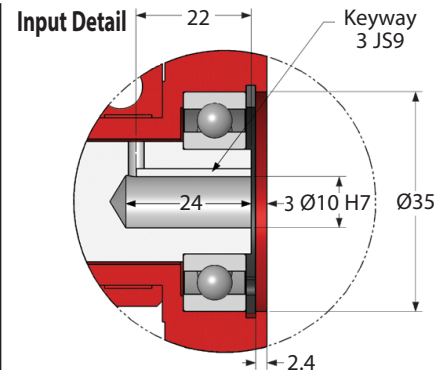
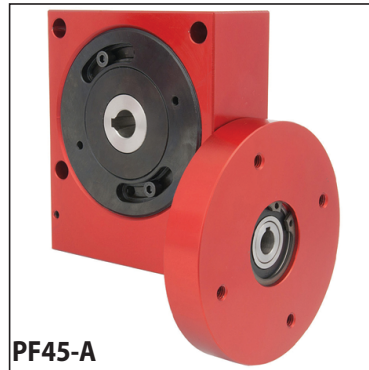
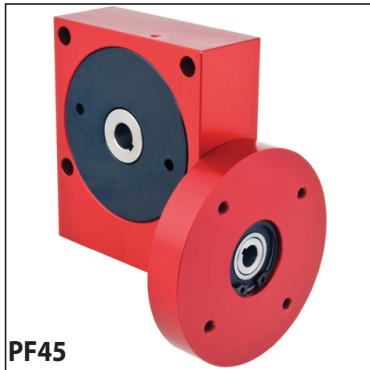

PF45A version (low backlash) output is on eccentric so centres will vary

Standard ≤30'	Part Number Low Backlash ≤8'	Part Number Red. Backlash ≤4'	Ratio	Efficiency at 1000 Rpm	Reflected Inertia at Input (kg.m ²)	Self Locking Output
PF45-10	PF45-10A	PF45-10AR	10:1	90%	7.34 x 10 ⁻⁶	✗
PF45-12	PF45-12A	PF45-12AR	12:1	89%	6.84 x 10 ⁻⁶	✗
PF45-15	PF45-15A	PF45-15AR	15:1	86%	6.43 x 10 ⁻⁶	✗
PF45-20	PF45-20A	PF45-20AR	20:1	85%	6.09 x 10 ⁻⁶	✗
PF45-30	PF45-30A	PF45-30AR	30:1	78%	5.86 x 10 ⁻⁶	✗
PF45-60	PF45-60A	PF45-60AR	60:1	67%	5.70 x 10 ⁻⁶	✓
PF45-120	PF45-120A	PF45-120AR	120:1	47%	5.66 x 10 ⁻⁶	✓
PF45-SP	PF45-SPA	PF45-SPAR	5:1-120:1	Special Ratios : Replace SP with required ratio		

Accessories

P45-X

Single Output Shafts

P45-DX

Double Output Shafts

KK4-25

Output Key

Weight: 1.15 kg. **Greased for Life:** Shell Gadus S5 V42P 2.5.
F_{xa} at 1000 Rpm: 45 kg. **F_a at 1000 Rpm:** 30 kg.

Tapped holes on input flange are not relative in position to the gearbox body and will alter from box to box. However, we can machine the tapped holes after assembly so they are relative in position to the gearbox body. This will affect delivery.

Motor Inputs also available.

Testing in your application is necessary.

You will need to assess duty cycles and confirm gearbox suitability with your own calculations.

All figures listed are to be used for guidance only.

Output Torque Nm

Rpm Input	Reduction Ratio						
	10:1	12:1	15:1	20:1	30:1	60:1	120:1
3000	10.3	10.8	11.3	12.2	13.2	14.7	10.8
2000	11.7	12.2	12.7	13.2	14.7	17.1	12.7
1000	14.7	15.2	16.2	17.1	18.1	20.6	14.3
500	19.1	19.6	20.6	21.6	22.5	24.5	17.5
200	24.4	25.5	26.4	27.0	28.9	30.0	20.6
100	28.3	28.9	29.4	30.3	31.8	33.8	22.8
50	32.3	32.8	33.8	34.3	34.5	35.2	23.0
10	39.9	39.9	39.9	40.0	40.0	40.0	23.0

sales@ondrives.us
www.ondrives.us

516-771-6777
516-771-6444

ondrives .US Corp.