

K40H

# GEARBOXES

K40H

## Worm & Wheel Reduction Gearbox

Molded Housings, Hollow Bore Output, **3:5:1 - 60:1**

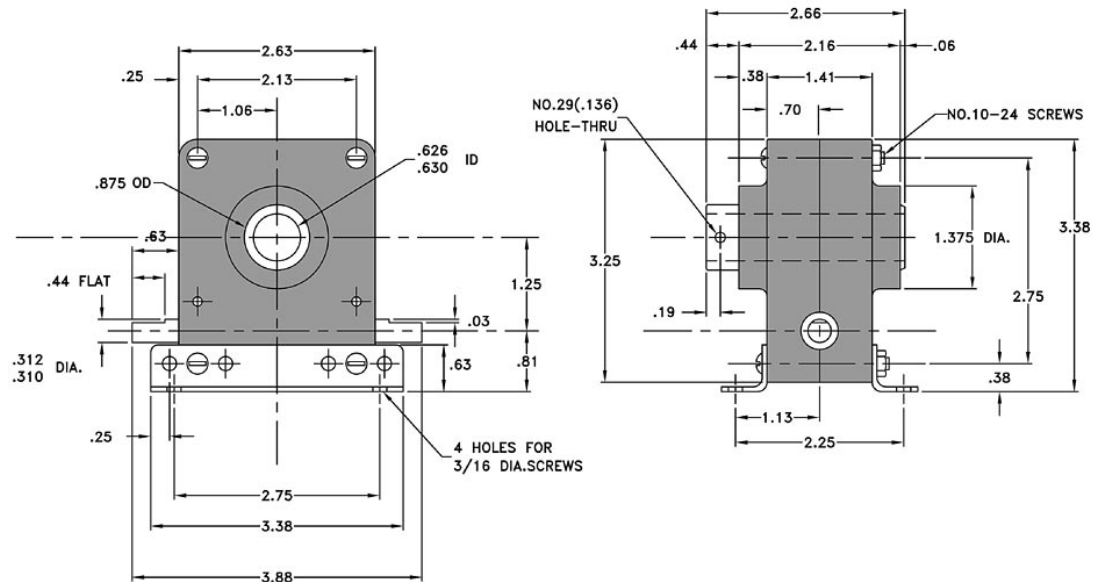
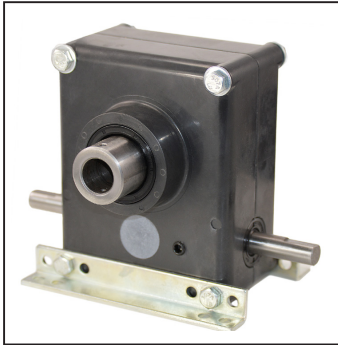

| Hollow Bore Output | Ratio | Input RPM | Output RPM | Output Torque |      |
|--------------------|-------|-----------|------------|---------------|------|
|                    |       |           |            | inch-LBS      | Nm   |
| K40H-3.5           | 3:5:1 | 1800      | 514.3      | 102           | 11.6 |
| K40H-10            | 10:1  | 1800      | 180        | 102           | 11.6 |
| K40H-15            | 15:1  | 1800      | 120        | 102           | 11.6 |
| K40H-20            | 20:1  | 1800      | 90         | 105           | 11.9 |
| K40H-30            | 30:1  | 1800      | 60         | 120           | 13.6 |
| K40H-40            | 40:1  | 1800      | 45         | 112           | 12.7 |
| K40H-48            | 48:1  | 1800      | 37.5       | 96            | 10.9 |
| K40H-60            | 60:1  | 1800      | 30         | 75            | 8.5  |

### Materials

Housing: Compression-molded glass filled polyster

Worm: Ground steel worm

Wheel: Bronze, precision hobbled

Modifications and custom designed gearboxes available. Customizing such as Stainless Steel shafting, longer shafts for input/output, and internal keyways on K40H output bores. Testing in your application is necessary. You will need to assess duty cycles and confirm suitability with your own calculations. All figures listed are to be used for guidance only.

### Specifications

Size: 3-3/8"H x 3-7/8"W x 3"D

Weight: less than 20 ounces

Input: Dual shaft 0.312" diameter with flats, steel, 0.63" long

Output: 0.625" diameter ground and polished steel with cross hole for securing shaft

Bearings: Input/Output shafts supported by sintered bronze bushings

Mounting: 8 different positions of the mounting flanges

**ondrives.us**

☎ 1-888-260-7466  
📄 516-771-6444

💻 sales@ondrivesus.com  
🌐 www.ondrivesus.com