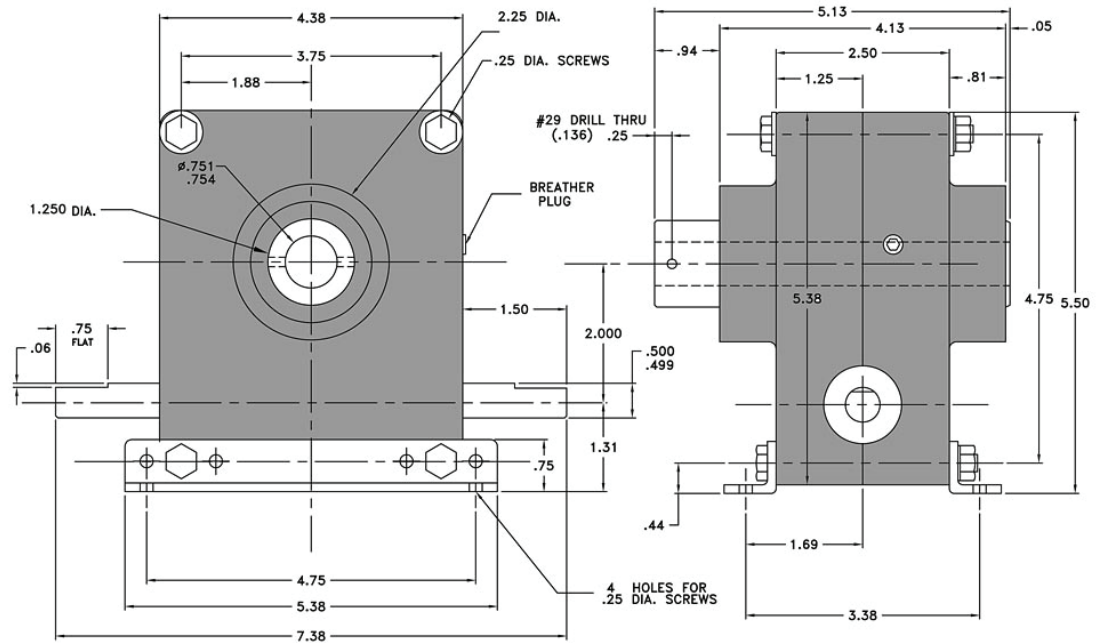
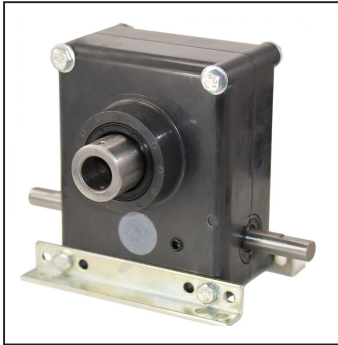

**K50H**

# GEARBOXES

**K50H**

## Worm & Wheel Reduction Gearbox

Molded Housing, Hollow Bore and Shaft Output **5:1 - 100:1**

Hollow Bore Output	Ratio	Input RPM	Output RPM	Output Torque	
				inch-LBS	Nm
<b>K50H-5</b>	5:1	1800	360	140	15.8
<b>K50H-9</b>	9:1	1800	200	175	19.7
<b>K50H-18</b>	18:1	1800	100	190	21.4
<b>K50H-25</b>	25:1	1800	72	190	21.4
<b>K50H-36</b>	36:1	1800	50	190	21.4
<b>K50H-50</b>	50:1	1800	36	190	21.4
<b>K50H-100</b>	100:1	1800	18	195	22.1

### Materials

Housing: Compression-molded glass filled Polyester

Worm: Ground steel worm

Wheel: Bronze, precision hobbled

Modifications and custom designed gearboxes available. Customizing such as Stainless Steel shafting, longer shafts for input/output, and internal keyways on K40H output bores. Testing in your application is necessary. You will need to assess duty cycles and confirm suitability with your own calculations. All figures listed are to be used for guidance only.

### Specifications

Size: 5-1/2"H x 7-7/8"W x 5-9/16"D

Weight: 9 pounds

Input: Dual shaft 0.500" diameter with flats, steel, 0.xx" long

Output: 0.750" diameter steel bore, 1.25 OD cross hole for securing shaft  
 Bearings: Input/Output shafts supported by sintered bronze bushings plus anti-friction thrust bearings

Mounting: 8 different positions of the mounting flanges

**ondrives.us**

☎ 1-888-260-7466

📠 516-771-6444

💻 sales@ondrivesus.com

🌐 www.ondrivesus.com